



OUTDOOR TECH[®]

2014



| Featured: The Turtle Shell 2.0
See page 4

WELCOME TO **ANOTHER ITERATION OF YOUR LIFE**. CALL IT AN IMPROVEMENT ON AN ALREADY GOOD THING. AND IF RYAN LIKES YOU, THEN THE REST OF US LIKE YOU AS WELL.

WALK WITH US DOWN THIS NEW ROAD. SHED THE THINGS THAT BIND YOU, AND MELD WITH THE **NEW SHINY**.

IF THESE WORDS MAKE YOU NERVOUS, THEY SHOULD. WE SEE YOU GLANCE AWAY FROM THE PAGE AS YOU THINK TO YOURSELF:

“I HAVE A JUICE BOX, SOME MICHAEL BUBLE ON VINYL, AND AN ODT CATALOG.... **CAN MY LIFE GET ANY BETTER?**”

HELL YES IT CAN.

BETTER THAN COFFEE AND CIGARETTES.

BETTER THAN COLD PIZZA AND WARM BEER.

BETTER THAN **NAKED TIME** AND, WELL, **MORE NAKED TIME**.

FROM THE BEGINNING WE SET OUT TO TAKE WHAT IS USEFUL AND MAINSTREAM, AND REMOLD IT. CRAFTING ITEMS WITH AS MUCH UTILITY AS SHOES WITH BUILT-IN NAILCLIPPERS, AND **MORE BEAUTIFUL THAN YOUR SISTER**. I KNOW YOU CAN'T SEE IT BUT WE THINK SHE IS KIND OF HOT.

CONSIDER US THAT EXTRA SPICE IN THE UNIVERSE YOU CRAVE. LIKE SRIRACHA, BUT WITHOUT THE BURNING “EXIT HOLE”.

CELEBRATE THE **NEW SHINY**, AND DROP US A LINE IF YOU ARE EVER IN THE AREA.

STAY CONNECTED BUT NOT TETHERED.



OUTDOOR
— TECH.

STUFF YOU PROBABLY WANT



TABLE OF CONTENTS.

SPEAKERS

BUCKSHOT WIRELESS SPEAKER 2

TURTLE SHELL[®] 2.0 WIRELESS BOOMBOX 4

TURTLE CLAW HANDLEBAR MOUNT 6

BIG TURTLE SHELL[®] WIRELESS BOOMBOX 8

HEADPHONES

DJ SLIMS WIRELESS HEADPHONES 10

PRIVATES WIRELESS HEADPHONES 12

TUIS WIRELESS HEADPHONES 14

BUDS N' STUFF

TAGS WIRELESS EAR-BUDS 16

ORCA ACTIVE WIRELESS EAR-BUDS 18

ADAPT WIRELESS TRANSMITTER 20

SNOW

CHIPS WIRELESS HELMET AUDIO 22

THE YOWIE[®] MAGICAL HEADWEAR 24



**BIG SOUND,
SMALL
PACKAGE.
WAIT...**

**THE BUCKSHOT,
SUPER-PORTABLE
RUGGED AND WATER-
RESISTANT SPEAKER.**

This is the Buckshot, the ultra-portable, multi-functional, rugged and water-resistant wireless speaker by Outdoor Tech®. It's the sneakiest little speaker on the block, so all you super-sneaky types look no further. The rugged, rubberized exterior means that it's no big deal if you drop it from time to time, and the built-in speaker-phone and microphone means that you can have hands-free calls with your therapist basically wherever you want.

//BUCKSHOT

It's like carrying an Iron Maiden around in your pocket. Groupies not included.



OT1301-B

BUCKSHOT - Rugged
Wireless Speaker - Black



OT1301-R

BUCKSHOT - Rugged
Wireless Speaker - Red



OT1301-GLO

BUCKSHOT - Rugged
Wireless Speaker - Glow in the
Dark



OT1301-EB

BUCKSHOT - Rugged
Wireless Speaker - Electric Blue



OT1301-AG

BUCKSHOT - Rugged
Wireless Speaker - Army Green

//FUNCTION

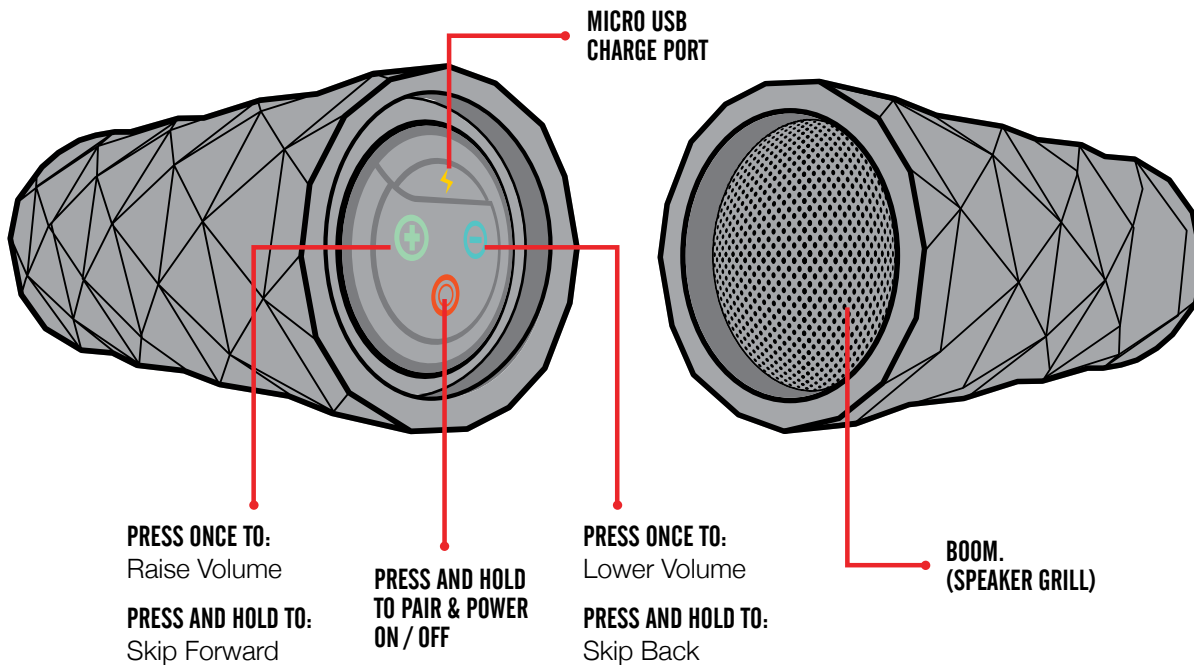

HANDLEBAR MOUNT INCLUDED



//FEATURES

- Big sound, tiny package. Stop laughing.
- Wirelessly connect to any Bluetooth-enabled device
- Included bicycle handlebar mount accessory
- IPX5 dust and water resistant standard
- Rugged, minimal design
- Built-in microphone
- Rechargeable lithium-ion battery
- Play time: 16 hours
- Range: 32 feet from device
- Weight: 5.2 oz

Included:

USB charging cable, handlebar mount, and user manual



**NOT BIGGER,
BUT BETTER.
YES, THAT'S
POSSIBLE.**

2.0

**20% LOUDER,
CLEANER SOUND
& BLUETOOTH 4.0.
DON'T THANK US,
THANK SCIENCE.**

We wouldn't say something as cliché as "The best just got better"... it did though. Designed from the ground up at our Los Angeles headquarters, it features an angular, triangle-themed construction that fits in as well on your coffee table as it does out in the elements. Its water-resistant, dust-proof and shock-proof shell is probably tougher than you are, and its built-in microphone functionality means you'll be double-fisting Dr. Peppers and having hands-free conference calls before you know it.

//TURTLE SHELL 2.0

Same shape and size, new guts and soul.



Bluetooth®



OT1800-B

TURTLE SHELL - Wireless Boombox - Black

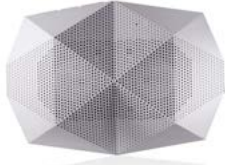

OT1800-W

TURTLE SHELL - Wireless Boombox - White

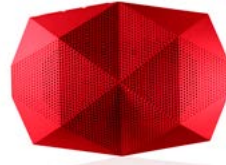

OT1800-R

TURTLE SHELL - Wireless Boombox - Red

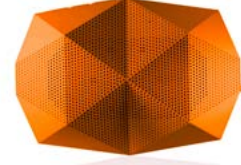

OT1800-O

TURTLE SHELL - Wireless Boombox - Orange

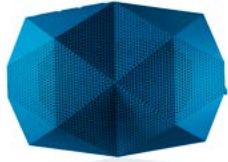

OT1800-EB

TURTLE SHELL - Wireless Boombox - Electric Blue

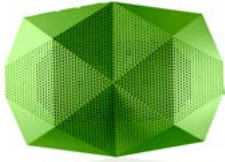

OT1800-G

TURTLE SHELL - Wireless Boombox - Neon Green



OT1800-P

TURTLE SHELL - Wireless Boombox - Purple

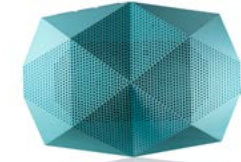

OT1800-SF

TURTLE SHELL - Wireless Boombox - Sea Foam

//FUNCTION

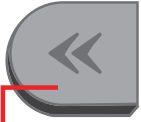

PRESS ONCE TO:
Lower Volume
PRESS AND HOLD TO:
Skip Back



PRESS ONCE TO:
Answer / Hang Up
Play / Pause
PRESS AND HOLD TO PAIR

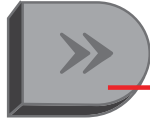

PRESS ONCE TO:
Raise Volume
PRESS AND HOLD TO:
Skip Forward



//FEATURES

- Two speakers and passive bass radiator provide 96 decibels of clear sound, wirelessly (20% louder than the original Turtle Shell®)
- Connect to any Bluetooth-enabled device with easy one-touch pairing
- Rechargeable lithium-ion battery with 16 hours of play time
- IPX-65 dust-proof and water resistant. We tested it. It passed.
- Built-in microphone, 'cause you've got a lot to say
- External controls allow you to adjust volume, change tracks, play/pause and answer calls
- Standard camera threading for multiple mounting options
- 3.5mm audio-in port in case you are still rocking a Walkman
- Bluetooth 4.0 with aptX Codec for enhanced audio quality
- Voice prompts
- Battery Level "Fuel Gauge" displayed on source device
- Wireless Range: 32 feet
- Micro USB charge port

Included:

USB charging cable, 3.5mm to 3.5mm cable, stickers, signature ODT carry pouch and user manual

TAKE YOUR TURTLE SHELL® EVERYWHERE.



**THE TURTLE CLAW LETS YOU MOUNT
YOUR TURTLE SHELL® TO ANYTHING
1.5" THICK OR LESS. ANYTHING...**

With the combined ruggedness of the Turtle Shell® and the functionality of the Turtle Claw, you can finally ride your bike in the rain while singing your heart out to Jeremy Beeber, or whatever kids are listening to today. Be it a bike, baby stroller, or your little brothers earlobe, the Turtle Claw lets your Turtle Shell® truly go anywhere.

//TURTLE CLAW

“Sweet bike, bro” -add the Turtle Shell 2.0 to your bicycle with the Turtle Claw, and you’ll be hearing that a lot.



OT3800

TURTLE CLAW - Handlebar
Mount for Turtle Shell

//FUNCTION

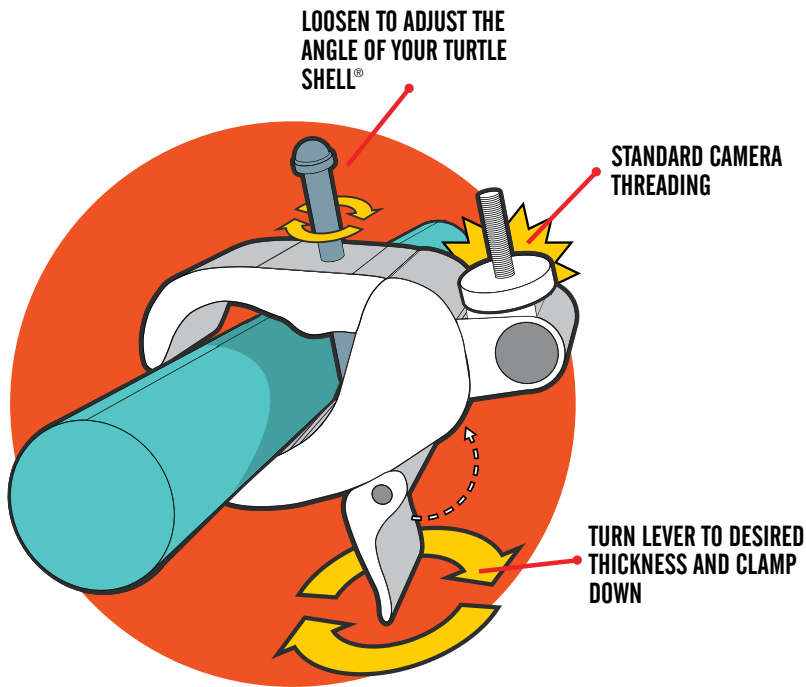

TWIST, CLAMP, GO

Turn the lever clockwise until the clamp is just big enough to fit around the object. Press the lever down to firmly attach the Turtle Claw to the object.



//FEATURES

- Standard camera threading holds your Turtle Shell® firmly to the claw
- Attach your Turtle Shell® to literally anything with a 1.5 inch diameter or less

Included:

The hopes and dreams of every child on earth

THIS ONE MIGHT PISS OFF THE NEIGHBORS.



**THE BIG TURTLE SHELL®,
THE T-REX OF WIRELESS
SPEAKERS...
MINUS THOSE ADORABLE
LITTLE ARMS.**

This is the Big Turtle Shell® by Outdoor Tech®, the world's loudest ruggedized and water-resistant Bluetooth wireless speaker. It's really loud. Like, rattle-your-teeth, shatter-the-fish tank, honestly-bro-I-can't-hear-you-loud. Noise violations, anyone? Of course, you can play it softly if you want, but that's sort of like riding on the lower level of a double-decker bus. Just like its little bro the Turtle Shell®, the Big Turtle Shell® features a water resistant, ruggedized body and a passive bass radiator, ensuring your dubstep has the required... dub.

//BIG TURTLE SHELL®

The Big Turtle Shell® is a water-resistant opera house, minus the, you know, opera.



OT4200-B

Big Turtle Shell® - Black



OT4200-GR

Big Turtle Shell® - Gray

//FUNCTION



Big Turtle Shell® Footprint



Turtle Shell 2.0® Footprint



PRESS ONCE TO:
Lower Volume

PRESS AND HOLD TO:
Skip Back



PRESS ONCE TO:
Answer / Hang Up
Play / Pause



PRESS ONCE TO:
Raise Volume

PRESS AND HOLD TO:
Skip Forward

3.5mm LINE IN &
LINE OUT

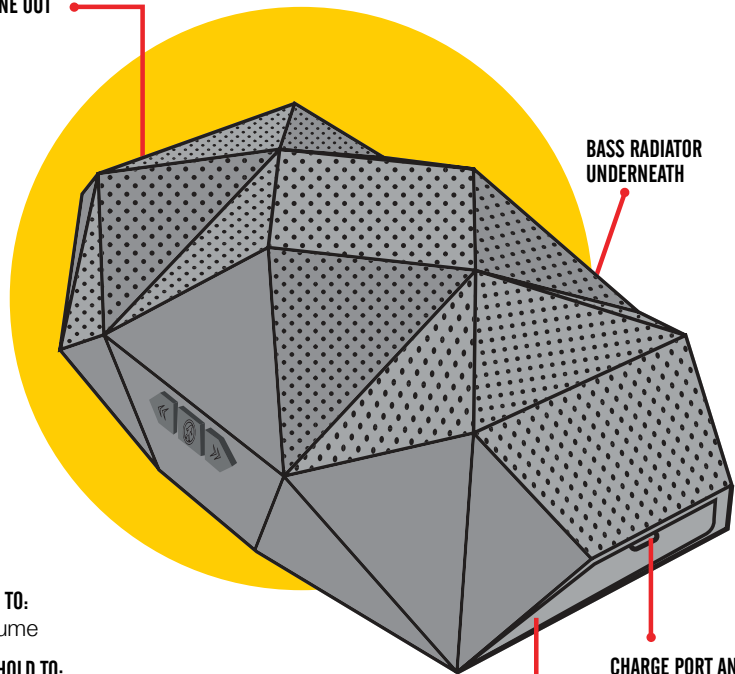

BASS RADIATOR
UNDERNEATH

BUILT IN CARRYING
HANDLES

CHARGE PORT AND USB
BATTERY BACKUP

//FEATURES

- Connect to any Bluetooth-enabled device with easy one-touch pairing
- Rechargeable lithium-ion battery
- IPX5 dust-proof and water-resistant
- Built-in microphone
- External controls allow you to adjust volume, change tracks, play/pause and answer calls
- Rugged, minimal design
- Twin grab handles built into the base for easy transport and limitless hanging/strapping options
- 3.5mm audio-in port
- 3.5mm audio out allows you to play two Big Turtle Shells off of one device

- Reconnects automatically to previously paired device
- NFC for easy pairing
- Powerful battery power bank with USB out
- Bluetooth 4.0
- Voice prompts
- Wireless range: 32 feet

Included:

AC adapter, USB charging cable, 3.5mm to 3.5 mm cable, and instruction manual

**PROBABLY
TOUGHER
THAN YOU.**



**THE DJ SLIMS, RUGGED
WIRELESS HEADPHONES.
YOU PROBABLY CAN'T BREAK
THEM, NOT THAT YOU'RE A
NANCY OR ANYTHING...**

The DJ Slims are rugged, wireless headphones with a built-in microphone for hands-free call functionality. Tread the road that beckons, and take your music along. These headphones are all about low-profile, lightweight execution. The super slim shape lends itself well to staying in place during your daily jaunt down to last call at Happy Hour, and the lightweight headband is coated with the same rugged, rubberized finish as many other ODT products. Mountain-tested, office-appropriate.



//DJ SLIMS

Tread the road that beckons, and take your music along.



OT1100
DJ SLIMS - Bluetooth Headphones
- Black



OT1101
DJ SLIMS - Bluetooth Headphones
- Blue



OT1102
DJ SLIMS - Bluetooth Headphones
- White

//FUNCTION

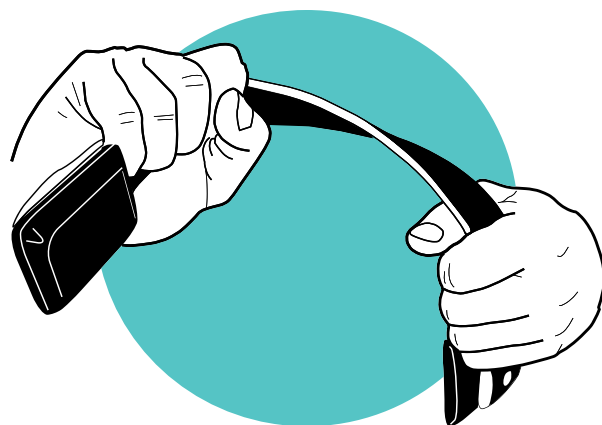
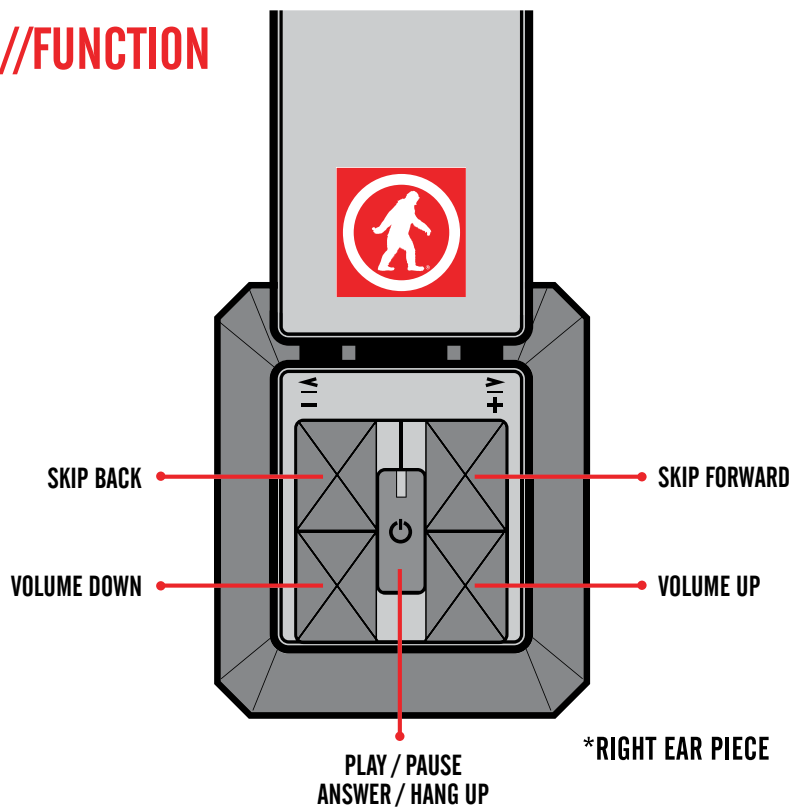

SUPER DURABLE

*But seriously - don't try to break them.
Grow up.

//FEATURES

- 30mm drivers deliver the full range of clear sound, wirelessly
- Built-in microphone
- Connect to any Bluetooth-enabled device with easy one-touch pairing
- External controls allow you to adjust volume, change tracks, play/pause and answer calls
- Rechargeable lithium-ion battery
- Play time: 9 hours
- Standard micro USB charge port
- Battery level "fuel gauge" displayed on source device
- Bluetooth 3.0

Included:

USB charging cable, signature ODT carry pouch, and user manual

TOUCH YOUR PRIVATES IN PUBLIC.



THE “PRIVATES” WIRELESS HI-FI HEADPHONES WITH A TOUCH PAD INTERFACE.

The Privates feature a touch pad interface on the right earpiece that allows you to change tracks and control volume with the swipe of a finger, built-in call functionality, a 3.5mm AUX jack for plug-in capability and a tough canvas wrap around the headband. The Privates are better-looking than a glass of scotch after that middle-seat flight between Sweaty Mister Johnson and Screaming Baby Timmy and more convenient than a twelve gauge when the zombies end up at your front door.



//PRIVATES

Privates come in every color, shape, and size. Ours just come in different colors.



- OT1400-B**
PRIVATES - Touch
Headphones - Black
- OT1400-AG**
PRIVATES - Touch
Headphones - Army Green
- OT1400-CA**
PRIVATES - Touch
Headphones - Canary
- OT1400-T**
PRIVATES - Touch
Headphones - Turquoise
- OT1400-GR**
PRIVATES - Touch
Headphones - Gray
- OT1400-P**
PRIVATES - Touch
Headphones - Purple-ish
- OT1400-C**
PRIVATES - Touch
Headphones - Crimson

//FUNCTION

CONTROLS:

SWIPE RIGHT:
Skip Forward

SWIPE LEFT:
Skip Back

SWIPE UP:
Raise Volume

SWIPE DOWN:
Lower Volume

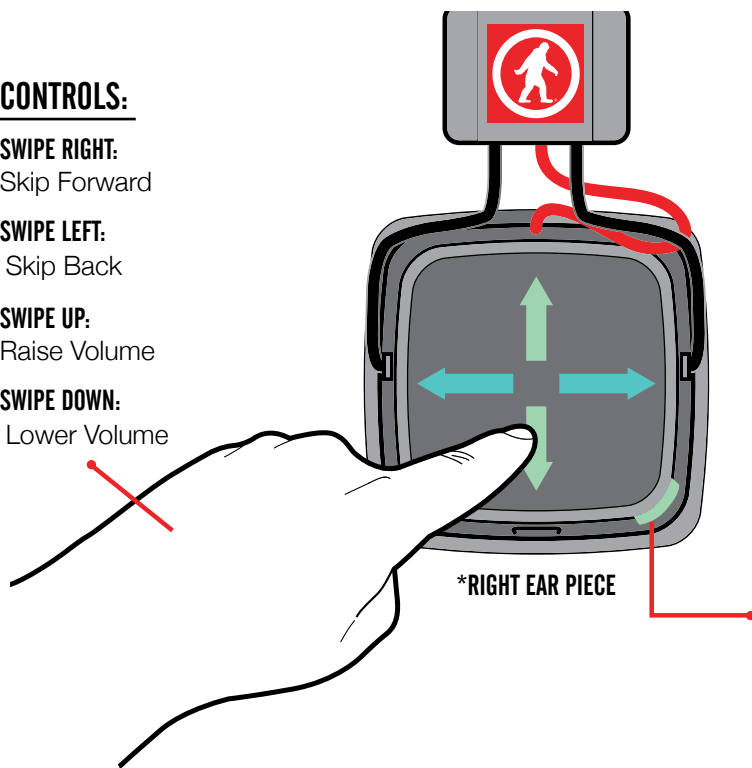

PRESS ONCE TO:
Answer / Hang Up
Play / Pause

PRESS AND HOLD TO:
Pair & Power On / Off

FOLD FOR PORTABILITY



*No yoga required.

//FEATURES

- 40mm drivers for clear mids and solid bass
- Built-in microphone for making and receiving calls
- Real, real comfortable, swiveling ear pads
- Only ONE button (yes, really). The rest is touch control, pretty cool.
- Bluetooth 3.0
- Works with any Bluetooth-enabled device
- Battery level "fuel gauge" displayed on source device
- 3.5mm AUX jack
- Foldable and flexible
- Play time: 10 hours

Included:

USB charging cable, 3.5mm to 3.5mm cable, signature ODT carry pouch, and user manual

THE TUIS {two:ees} KINDA THINK...



THEY'RE
BETTER
THAN YOU.

**PERHAPS THEY'RE A
BIT PRETENTIOUS,
BUT YOU'D BE TOO IF
YOU SOUNDED THIS
GOOD.**

“Better than me?”, you ask. Probably. They’re named after the flashiest bird in New Zealand, one with iridescent plumage, two voice boxes and a bit of an attitude. They are packed with the finest features including, HI-FI sound, real comfortable ear pads and headband, integrated 3.5mm auxiliary jack, on-screen fuel gauge, and integrated hinges for folding and transport. The Tuis fit in well aside a glass of single-malt and box of Arturo Fuentes, although they can also work with a milkshake and one of those old-school Game Boys. Sometimes that’s just as classy.



//TUIS

According to the Tuis, you may not have the mental capacity to handle these.



OT3200-B

TUIS - Bluetooth Headphones - Black



OT3200-GR

TUIS - Bluetooth Headphones - Grey



//FUNCTION

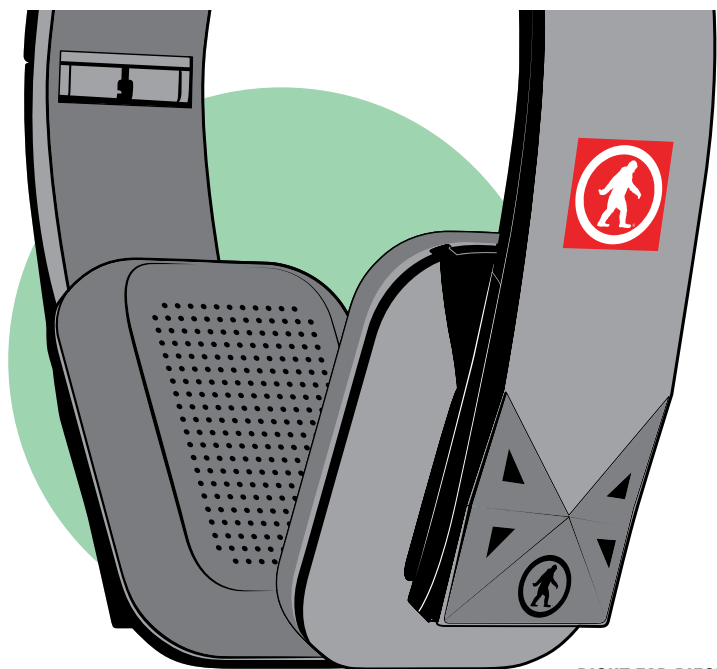

*RIGHT EAR PIECE

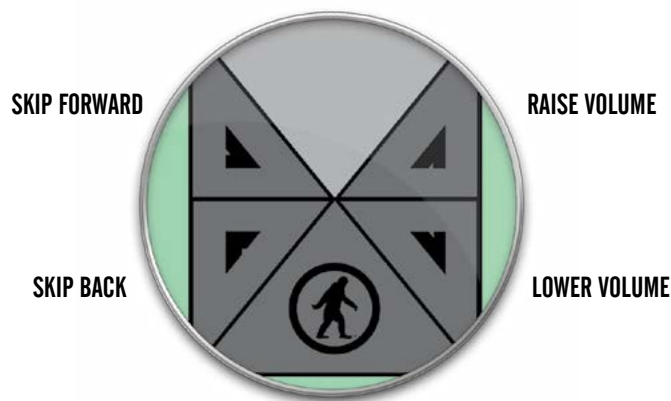

PRESS ONCE TO:
 Answer / Hang Up
 Play / Pause

PRESS AND HOLD TO:
 Pair & Power On / Off

//FEATURES

- 40mm drivers deliver the full range of clear sound, wirelessly
- Connect to any Bluetooth-enabled device with easy one-touch pairing
- External controls allow you to adjust volume, change tracks, play/pause and answer calls
- Rechargeable lithium-ion battery
- Built-in microphone
- Built-in 3.5mm AUX jack
- Reconnects automatically to previously paired device
- Battery level “fuel gauge” displayed on source device
- Premium HI-FI sound
- Integrated hinges for easy folding and compact portability
- Bluetooth 4.0
- AptX Audio Codec for enhanced audio quality
- Play time: 16 hours

- Standby time: 400 hours
- Wireless range: 32 feet

Included:
 USB charging cable, 3.5mm to 3.5mm cable, hard shell travel case, and user manual



//TAGS

When you're not jamming out to "phat" beats, rock them around your neck like dog tags.



OT1000

TAGS - Bluetooth Ear Buds - Black



OT1002

TAGS - Bluetooth Ear Buds - White



OT1003

TAGS - Bluetooth Ear Buds - Blue

SPORT EARCLIPS INCLUDED

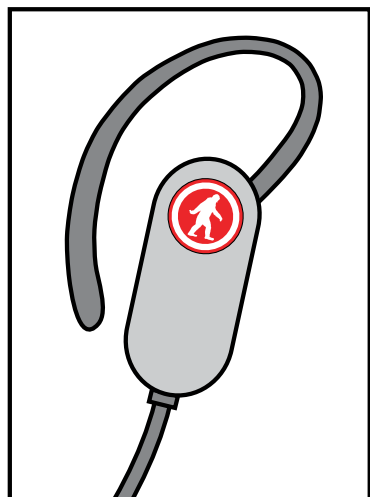

GET SHWEATY.

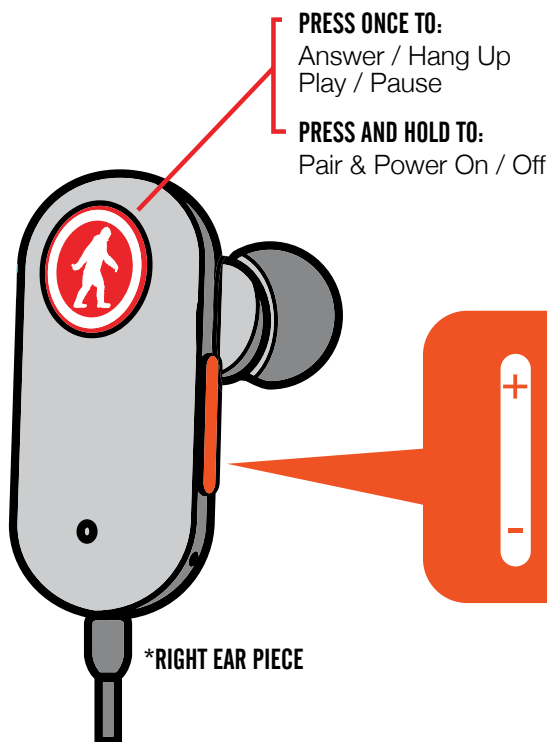

//FEATURES

- Lightweight wireless audio ear buds deliver rich, clean sound with 8mm drivers
- Wirelessly connect to any Bluetooth-enabled device with easy one-touch pairing
- Rechargeable lithium-ion battery
- Built-in microphone
- External controls allow you to adjust volume, change tracks, play/pause and answer calls
- Reconnects automatically to previously paired device
- Play time: 6 hours

Included:

USB charging cable, signature ODT carry pouch, sport ear clips, 3 ear-bud sizes, and instruction manual



**STICK EM'
IN YOUR
BLOW
HOLES.**

**ACTIVE EAR-BUDS
WITH A BLUETOOTH 4.0
RANGE OF 32 FEET. SO
YOU CAN **BREAK AWAY**
FROM THE POD.**

The Orcas are sweatproof and splash resistant. Perfect for anyone who likes running. Or rain. Or running in the rain. Or not. Because that just sounds terrible. They also offer handsfree controls and a built in mic for calls. It's kind of like having a personal butler in your ear.

//ORCAS

Incredibly secure, lightweight fit. Like your favorite pair of bloomers that you've held on to for way, way too long.



OT5200-R

ORCAS - Active Wireless Earbuds - Red



OT5200-B

ORCAS - Active Wireless Earbuds - Black

//FUNCTION

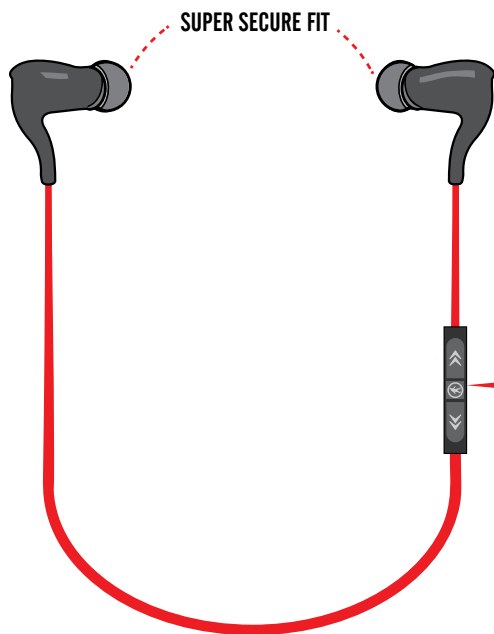

PRESS UP:
Raise Volume

HOLD UP:
Skip Forward

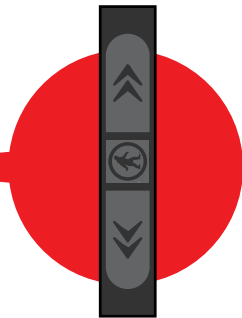

PRESS CENTER TO
Play / Pause
Answer / Hang up

PRESS DOWN:
Lower Volume

HOLD DOWN:
Skip Back

THE ORCA "FINS" PROVIDE A SUPER LEGIT FIT.

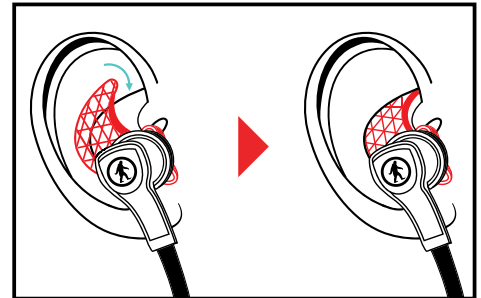

6 HOURS
RECHARGEABLE PLAY AND
TALK TIME.

//FEATURES

- Sweatproof and splash resistant
- Bluetooth 4.0 with a range of 32 feet
- Built In Microphone
- Headset and handsfree controls A2DP v1.2 and AVRCP v1.4
- Sound enhancement with apt X and AAC
- Micro USB charge port
- Play Time: 6 hours
- Standby Time: 150 hours

Included:

3 sizes of ear tips, 3 sizes of secure fit ear cushions, USB Charging Cable, ODT Carry Pouch and User Manual

MAKE IT BLUETOOTH.



**THE ADAPT, BLUETOOTH ADAPTER.
WIRES NOW MAKE AS MUCH SENSE
AS SCREEN DOORS ON SUBMARINES.**



The Adapt will make anything with a 3.5mm audio jack wireless. Now you may talk on the phone with your old headphones or turn your car stereo into a speaker-phone with its built-in mic. Make sure to clip it to your favorite sweater vest for a totally hands-free experience. You may also skip tracks and control volume without having to touch your Bluetooth device. Your life is getting easier just reading this.



//ADAPT:

Use this little guy with ear-buds, headphones, or jack it into your dad's home stereo.



OT6001

ADAPT - Clip Bluetooth Adapter - Black



OT6002

ADAPT - Clip Bluetooth Adapter - Blue



OT6003

ADAPT - Clip Bluetooth Adapter - Pink



OT6004

ADAPT - Clip Bluetooth Adapter - Orange



OT6005

ADAPT - Clip Bluetooth Adapter - Yellow

//FUNCTION

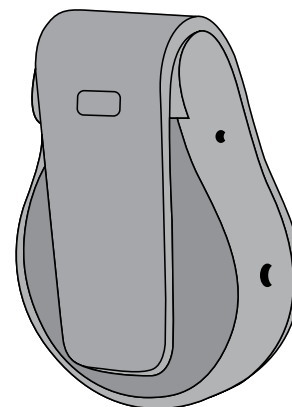
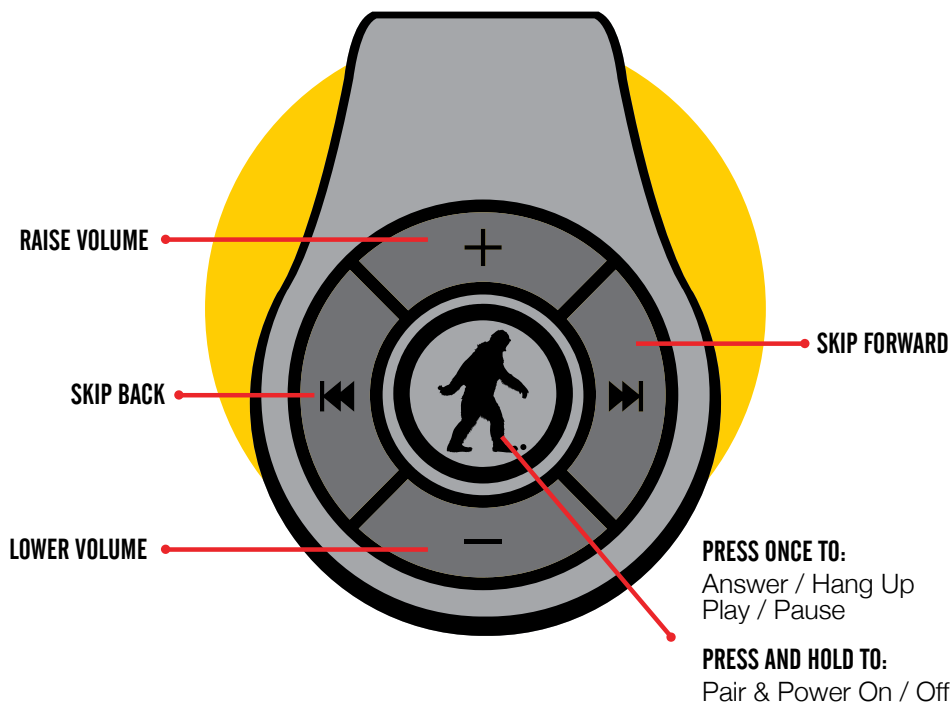

Handy clip, for you know.. clipping to things.

//FEATURES

- Adds wireless audio, microphone and control to any 'wired' product you have
- Connect to any Bluetooth-enabled device with easy one-touch pairing
- External controls allow you to adjust volume, change tracks, play/pause 'Harry Potter on Tape' and answer calls
- Microphone features noise suppression, echo elimination and duplex sound for crystal clear quality calls
- Sport clip
- Reconnects automatically to previously paired device
- Built-in Li-Polymer/rechargeable battery
- Play time: 6 hours
- Standby time: 150 hours
- Wireless range: 32 feet

Included:

USB charging cable and user manual

**WE GIVE
GREAT
HELMET.**



**THE CHIPS WORK
WITH ALMOST EVERY
SNOW HELMET.**

These are the Chips, the universal, wireless helmet audio system by Outdoor Tech®. Connect them to any Bluetooth® device, drop them into nearly any helmet with an audio liner and your skull will be dripping with Kenny G.'s undeniable melodies for up to the next ten hours. They feature the ability to play and pause, raise and lower volume, answer calls and skip tracks from the Chips' two button interface, all without removing your mittens. This means warm hands, fresh powder, total audio control, and no wires.

//CHIPS

Not to be confused with the delicious potato snack. So tasty.



OT0032

CHIPS - Universal Wireless
Helmet Audio

//FUNCTION

PRESS TWICE:
Raise Volume

PRESS ONCE:
Lower Volume

SKIP FORWARD:
Hold Until Song
Skips

SKIP BACK:
Hold For 3
Seconds

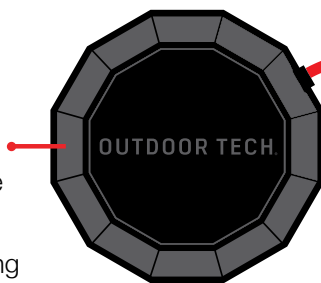

*Left ear piece

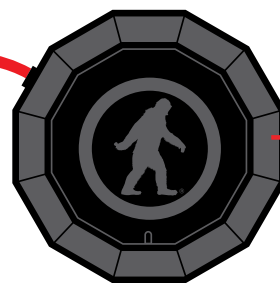

*Right ear piece

PRESS ONCE TO:
Answer / Hang Up
Play / Pause

PRESS AND HOLD TO:
Pair & Power On / Off

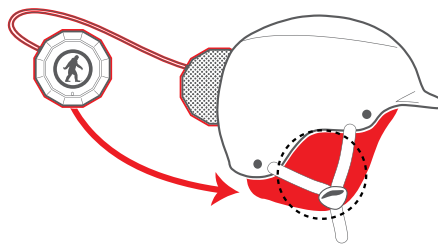

1 Drop the Chips into the slots inside your helmet liner.

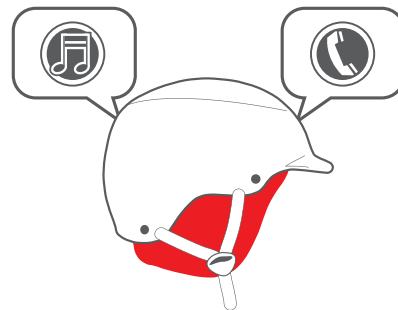

2 Rock out and make calls without taking off your helmet.

//FEATURES

- Rechargeable lithium-ion battery
- Built-in microphone
- Patented 2-button control system allows you to adjust volume, change tracks, play/ pause music and answer calls from outside your helmet knit without removing your gloves
- Rugged, minimal design fits into virtually any helmet designed to take audio drop-ins
- IPX-4 sweat and water resistant
- Tested to work perfectly at -20° C/-4°F
- Reconnects automatically to previously paired device
- Siri activation for hands-free calls, texts or weather related questions
- Play time: 10 hours
- Standby time: 280 hours
- Wireless range: 32 feet

Included:

USB charging cable, 3.5 to micro USB converter, 3.5mm to 3.5mm cable with volume and mute control, ODT signature carry pouch, and user manual

*Global Patents Pending

**JUST
PRETEND
SHE'S IN
THE SNOW.**

//THE YOWIE® & ARCTIC YOWIE®

Face-mask, beanie, head sock, dog sweater, security blanket, neck warmer, bandana, etc...



Merica:
Reg: OT2028
Arctic: OT2528



The Law (red):
Reg: OT2024
Arctic: OT2524



The Law (white):
Reg: OT2025
Arctic: OT2525



The Law (blue):
Reg: OT2026
Arctic: OT2526



Spacewalk:
Reg: OT2003
Arctic: OT2503



Keff-Yeah:
Reg: OT20010
Arctic: OT2510



El Jefe:
Reg: OT2029
Arctic: OT2529



The Law (tie-dye):
Reg: OT2027
Arctic: OT2527



Chill Face:
Reg: OT2030
Arctic: OT2530



OT Native:
Reg: OT2031
Arctic: OT2531



Redrum:
Reg: OT2005
Arctic: OT2505



Black Diamond:
Reg: OT2006
Arctic: OT2506



Halftone-Greyscale
Reg: OT2037
Arctic: OT2536



Halftone - Color
Reg: OT2038
Arctic: OT2537



Fair Isle:
Reg: OT2032
Arctic: OT2532



Rasta Fade:
Reg: OT2033
Arctic: OT2533



Gravy:
Reg: OT2034
Arctic: OT2534



Totes:
Reg: OT2035
Arctic: OT2535



Do Work:
Reg: OT2020
Arctic: OT2520



Pattern
Reg: OT2039
Arctic: OT2538



Crackalope:
Reg: OT2019
Arctic: OT2519



Four Dub:
Reg: OT2018
Arctic: OT2518



Border
Reg: OT2040
Arctic: OT2539



Animal
Reg: OT2041
Arctic: OT2540



Animal - Pink
Reg: OT2042
Arctic: OT2541



Coma - Beige
Reg: OT2043
Arctic: OT2542



Coma - Green
Reg: OT2044
Arctic: OT2543



Coma - Pink
Reg: OT2045
Arctic: OT2544



Captain Awesome:
Reg: OT2008
Arctic: OT2508

ARCTIC YOWIE®

BASIC YOWIE + FLEECE BOTTOM





OUTDOOR TECH®
5702 W. PICO BLVD
LOS ANGELES, CA 90019

FOR A GOOD TIME, CALL:
310-677-0190

OR EMAIL:
INFO@OUTDOORTECH.COM

www.outdoortech.com

WELL KIDS, ITS CLOSING TIME FOR THIS RAG.
WE HAD FUN BUILDING ALL THESE THINGS, USING SCHEMATICS,
FABRIC, CIRCUITS, METALS, **UNICORN TEARS**, BITS, HICKORY
OILS, AND AUDIO MAGIKA.
AT THIS POINT WE ARE PRETTY SPENT. ALL WE WANT TO DO IS
CRAWL INTO THE AIRSTREAM AND RAISE A BLOODY MARY TO TOAST
TO THE END...
BUT THIS IS NOT THE END.
JUST THE END OF THE CATALOG.
NOT THE END OF US.
WE WILL CONTINUE TO MAKE **STUFF YOU PROBABLY WANT**.
WELL TECHNICALLY THE OTHER SIDE OF THIS PAGE IS THE END.
YOU KNEW THAT.
GOODBYE.



TOODLES.



**OUTDOOR
— TECH —**

STUFF YOU PROBABLY WANT

www.outdoortech.com